

CROSS SECTION 'A'

CROSS SECTION 'B'

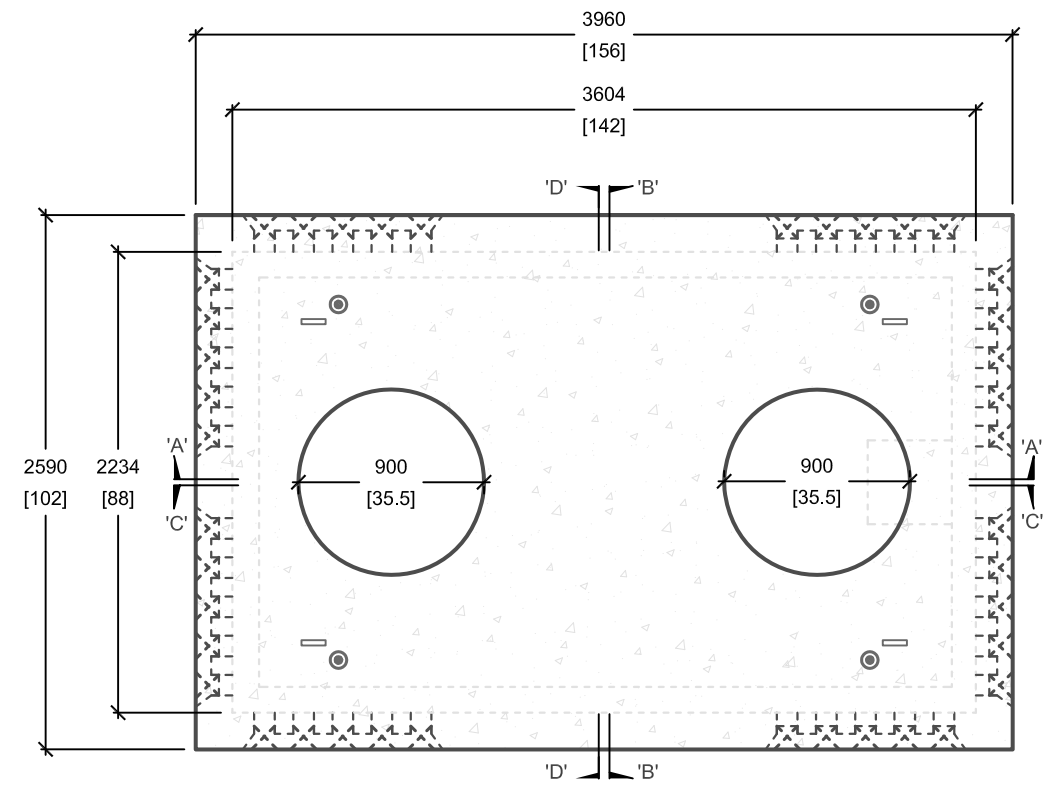

PLAN VIEW

(8) DUCT ENTRY WINDOW:
(10) 127mm[5"] POLYLOKS PER WINDOW
AT 190mm[7.5"] SPACING
SEE NOTE "A"

BUTYL RUBBER
GASKET APPLIED
TO JOINT

GALVANIZED
PULLING IRON
SEE NOTE "C"

8T SWIFT LIFT HOOK SYSTEM
(AS PER MANUFACTURERS SPECS)

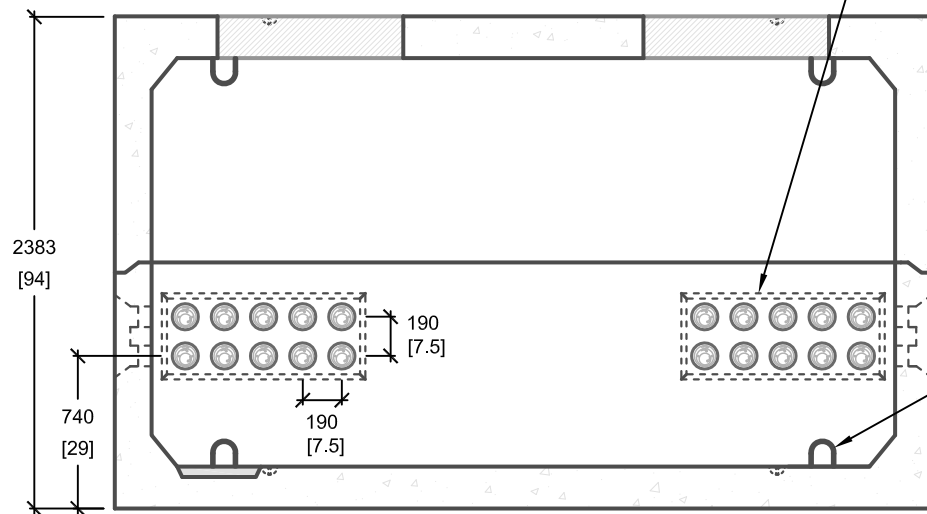

CROSS SECTION 'C'

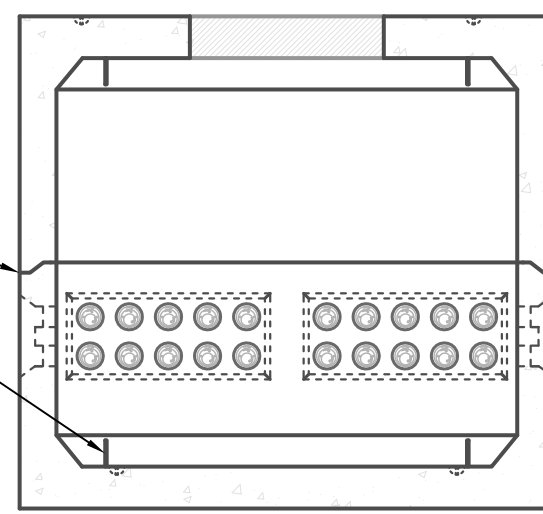

CROSS SECTION 'D'

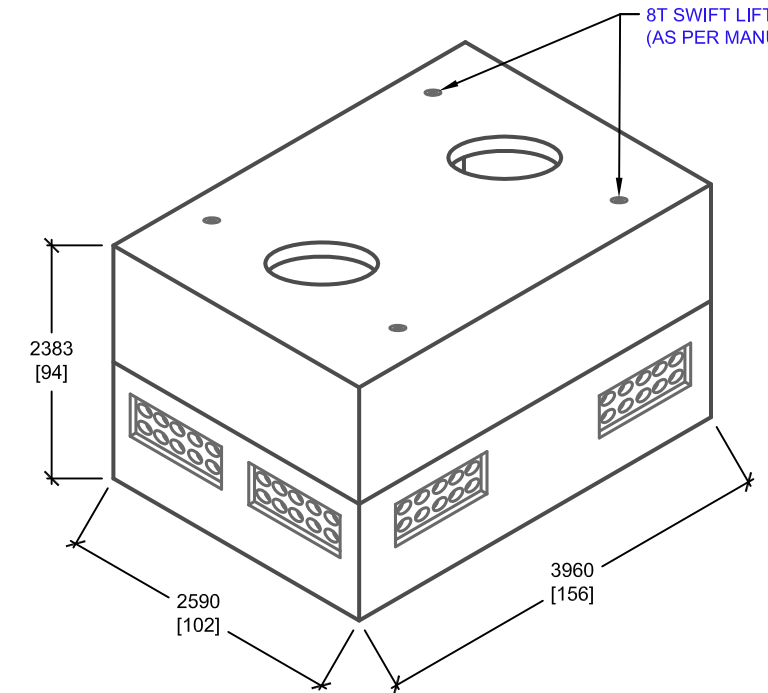

NOTE: MINIMUM SOIL BEARING CAPACITY TO BE 100kpa (TO BE CONFIRMED ON SITE / BACKFILLING TO BE APPROVED BY A GEOTECHNICAL ENGINEER)



UTILITY STRUCTURES INC.

61 BONGARD AVE | OTTAWA, ON | K2E 6V2
T: 613.225.6398 F: 613.225.1681 TF: 800.267.6466

www.utilitystructures.com

CONSTRUCTION DETAILS:

- AS PER HYDRO ONE DU-09-106-0500
- DESIGNED TO CL-625-ONT TRUCK LIVE LOADING AS PER CSA S6-06

• CSA 23.4-05

- 35 MPa (5000psi) AT 28 DAYS
- STRIPPING STRENGTH: MIN. 20 MPa(2900psi)
- 5-8% AIR ENTRAINED
- EXPOSURE CLASS: C-1
- REINFORCING: STEEL TO CSA CAN A23.1

NOTES:

- A. (8) 127mm[5"] POLYLOK PIPESEAL WINDOWS (10 POLYLOKS PER WINDOW)
- B. (1) 400mm[16"] x 400mm[16"] SUMP BOX
- C. (8) GALVANIZED PULLING IRONS
- D. (1) 126mm[5"] DRAIN OUTLET KNOCKOUT

PRODUCT DETAILS:

- INSIDE DIMENSIONS: 1.98m[78"](H) x 2234mm[88"] x 3604mm[142"]
- OUTSIDE DIMENSIONS: 2.39m[94"](H) x 2590mm[102"] x 3960mm[156"]

WEIGHTS:

- TOP: 9,520 kg / 20,945 lbs
- BASE: 9,900 kg / 21,780 lbs

CUSTOM OPTIONS AVAILABLE:

- CUSTOM WINDOWS, OPENINGS, CABLE RACKS, PULLING EYES & MANHOLE HEIGHT

PRODUCT CODE:

E-812 (HO)
8' x 12' ELECTRICAL MANHOLE

INSIDE DIMENSIONS:

2.39m(H) X 2234mm x 3604mm

ESTIMATED TOTAL WEIGHT:

19,420 kg / 42,725 lbs

REVISION DATE:

JANUARY 25, 2018

REV. # 4