

0.15m x 806mm [6" x 31.75"]
WATERTIGHT ELECTRICAL FRAME AND COVER

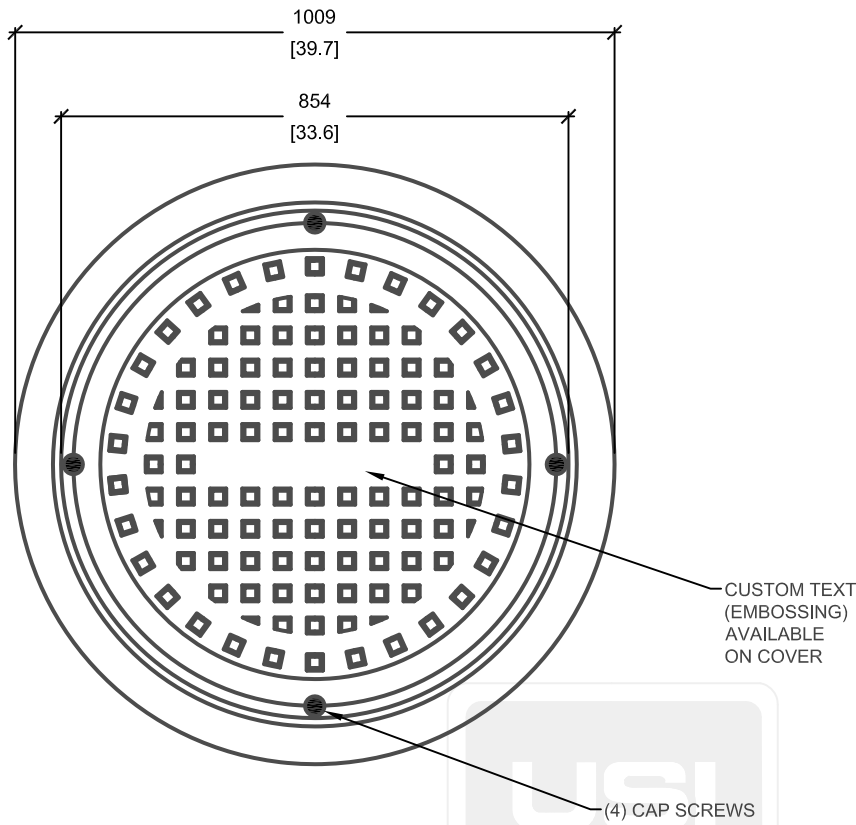

PLAN VIEW

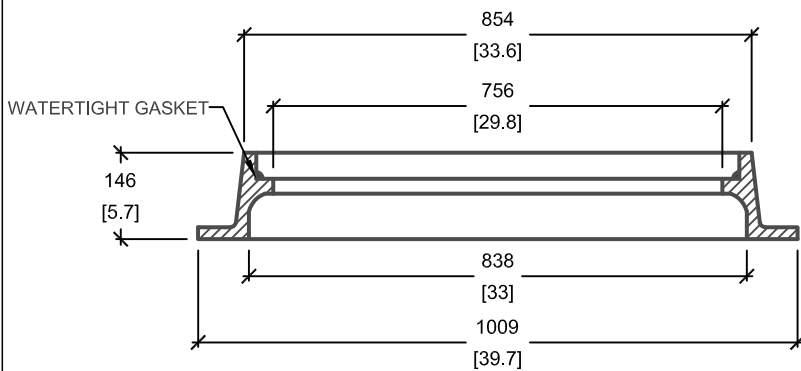
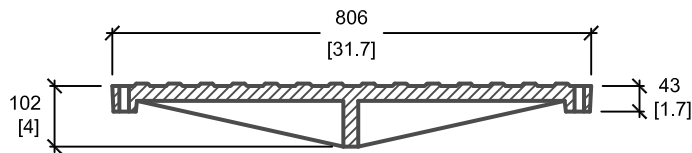

SIDE ELEVATION

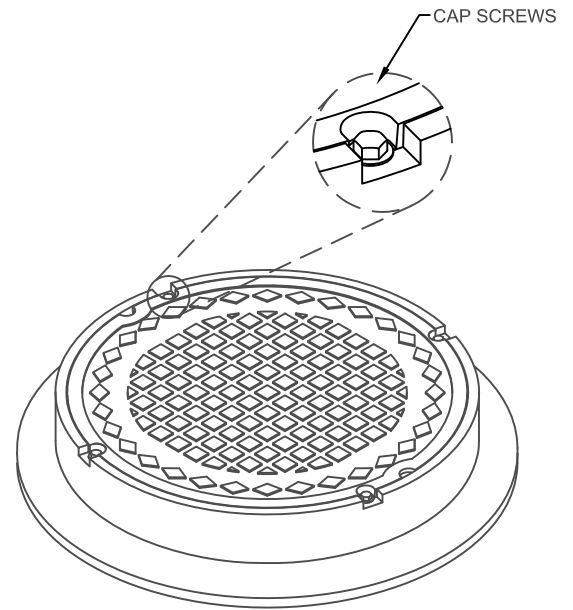

ISOMETRIC VIEW

mm
 [Inches]
 ALL DIMENSIONS DEFAULT TO MILLIMETRES



UTILITY STRUCTURES INC.

61 BONGARD AVE | OTTAWA, ON | K2E 6V2
 T: 613.225.6398 F: 613.225.1681 TF: 800.267.6466

www.utilitystructures.com

CONSTRUCTION DETAILS:

- REFERENCE MODEL # C-36
- WATERTIGHT CAST IRON FRAME & COVER
- CUSTOM TEXT EMBOSSING AVAILABLE
- CUSTOM LOGO EMBOSSING AVAILABLE

NOTES:

- SUITABLE FOR 762mm[30"] & 813mm[32"] ACCESS OPENINGS

PRODUCT CODE:

F-7W

WATERTIGHT ROUND FRAME & ROUND COVER

DIMENSIONS:

0.15m(H) X 806mm DIA.

TOTAL WEIGHT:

210 kg / 460 lbs

REVISION DATE:

JUNE 30, 2015

REV. # 3