

LOAD REQUIREMENTS	
DISTRIBUTED LATERAL LOAD	25 kN/m ²
TOP SLAB DISTRIBUTED LOAD	60 kN/m ²
TOP SLAB POINT LOAD	70 kN

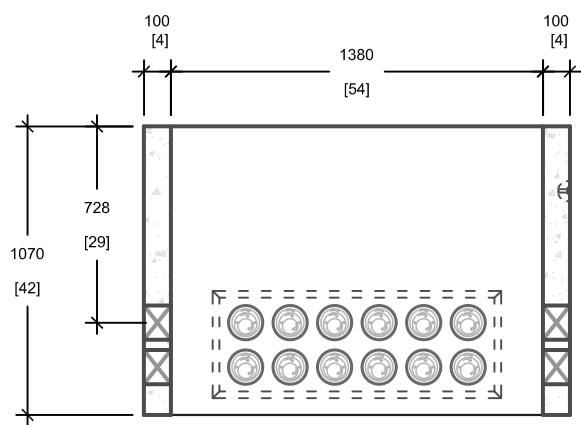

CROSS SECTION 'B'

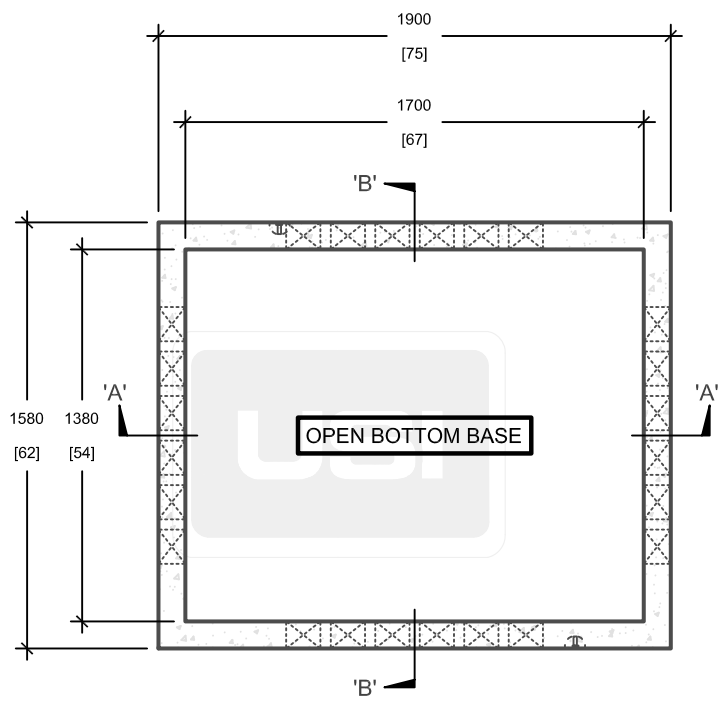

PLAN VIEW

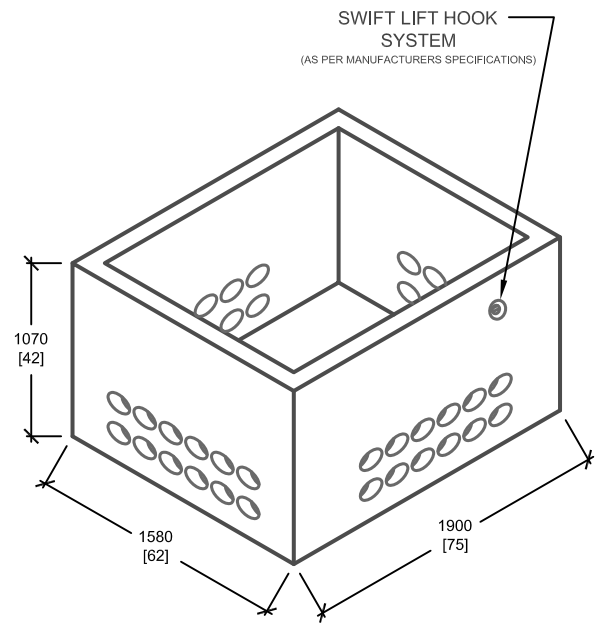

ISOMETRIC VIEW

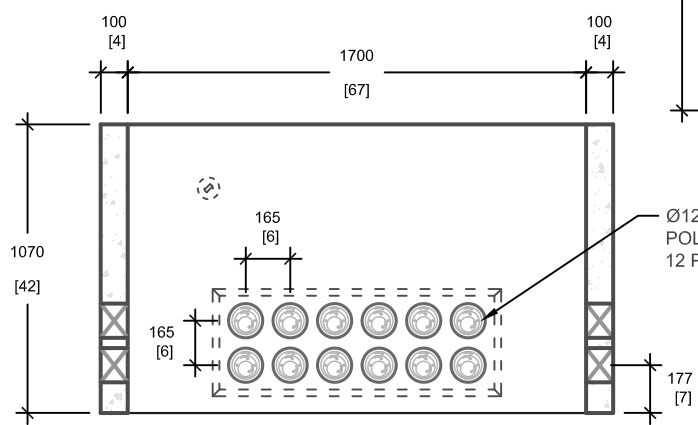

CROSS SECTION 'A'

Ø127mm [5] (TYP.)
POLYLOK PIPESEAL
12 PER SIDE

mm
[Inches]
ALL DIMENSIONS DEFAULT TO MILLIMETRES

NOTES:
 • SOIL BEARING CAPACITY TO BE MIN. 345kPa (SLS) OR USE A CONCRETE BASE PAD; VERIFY ON SITE.
 • SEISMIC ANCHORAGE FROM EQUIPMENT TO PAD AND PAD TO BASE TO BE PROVIDED BY OTHERS.



UTILITY STRUCTURES INC.
 61 BONGARD AVE | OTTAWA, ON | K2E 6V2
 T: 613.225.6398 F: 613.225.1681 TF: 800.267.6466
www.utilitystructures.com

CONSTRUCTION DETAILS:

- REFERENCE **HYDRO ONE DU-09-403**
- CSA A23.1
 - 35 MPa (5000psi) AT 28 DAYS
 - STRIPPING STRENGTH: MIN. 20 MPa(2900psi)
 - 5-8% AIR ENTRAINED
 - EXPOSURE CLASS: C-1
- REINFORCING: STEEL TO CSA G30.18

PRODUCT DETAILS:

- (4) 127mm[5"] POLYLOK PIPESEAL WINDOWS (12 POLYLOKS PER WINDOW)
- THREE PHASE PAD-MOUNTEDSWITCHGEAR (4 WAY) TRANSFORMER BASE
- CLOSED BOTTOM VERSION AVAILABLE (DWG# E-14B-ONT)
- USE WITH E-14 (403) TRANSFORMER PAD
- CUSTOM OPTIONS AVAILABLE:
 - CUSTOM WINDOWS & OPENINGS

PRODUCT CODE:	
E-14-ONT	
THREE PHASE TRANSFORMER BASE	
OUTSIDE DIMENSIONS:	
1.07m(H) X 1580mm x 1900mm	
TOTAL WEIGHT:	
1,700 kg / 3,740 lbs	
REVISION DATE:	REV. # 1
MAY 5, 2016	