

**CROSS SECTION 'B'**

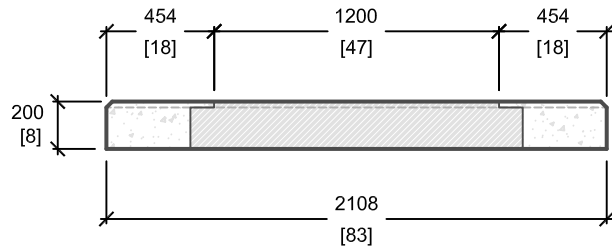

**CROSS SECTION 'A'**

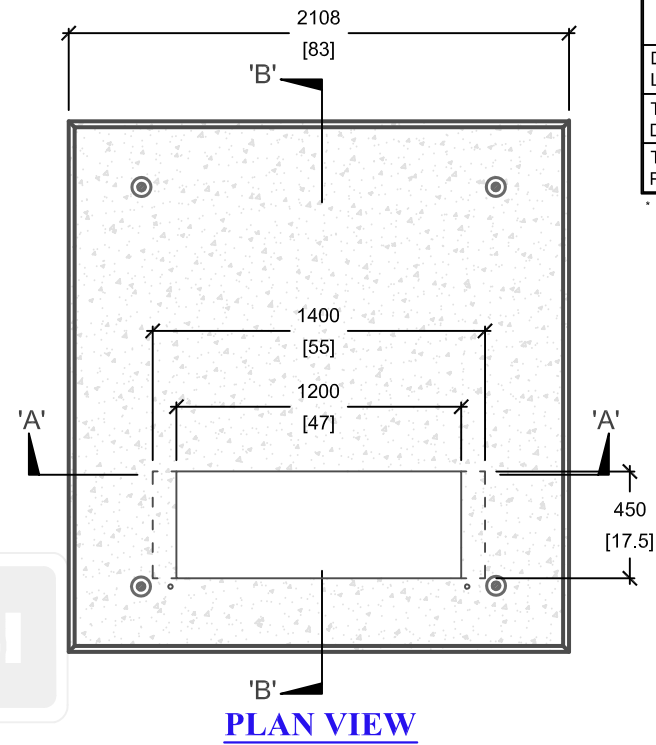

**PLAN VIEW**

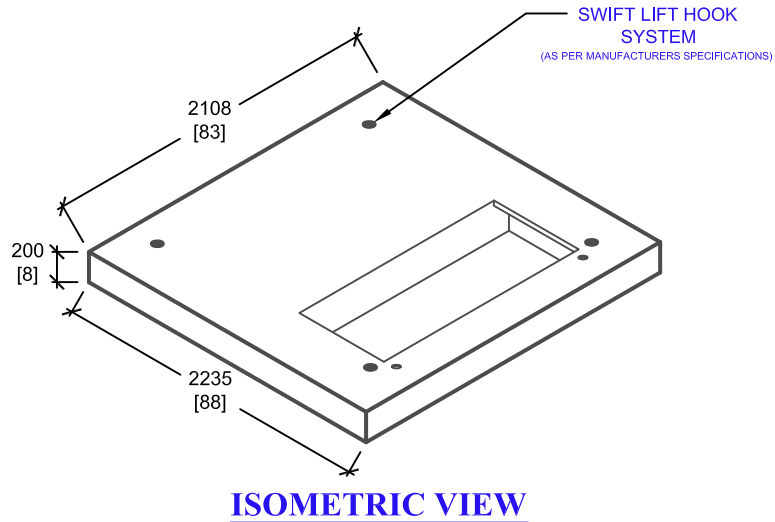

**ISOMETRIC VIEW**

LOAD REQUIREMENTS	
DISTRIBUTED LATERAL LOAD	25 kN/m <sup>2</sup>
TOP SLAB DISTRIBUTED LOAD	60 kN/m <sup>2</sup>
TOP SLAB POINT LOAD	70 kN

\* DISTRIBUTED AND POINT LOADS ON TOP SLAB SHALL NOT BE APPLIED SIMULTANEOUSLY.

mm [Inches]  
ALL DIMENSIONS DEFAULT TO MILLIMETRES



**UTILITY STRUCTURES INC.**

61 BONGARD AVE | OTTAWA, ON | K2E 6V2  
T: 613.225.6398 F: 613.225.1681 TF: 800.267.6466

[www.utilitystructures.com](http://www.utilitystructures.com)

**CONSTRUCTION DETAILS:**

- AS PER HYDRO OTTAWA UCS0035
- TO BE USED WITH BASE DWG# E-13 & E-37 SWITCHGEAR MANHOLE
- CSA 23.4-05
  - 35 MPa (5000psi) AT 28 DAYS
  - STRIPPING STRENGTH: MIN. 20 MPa(2900psi)
  - 5-8% AIR ENTRAINED
  - EXPOSURE CLASS:C-1
- REINFORCING: STEEL TO CSA CAN A23.1

**PRODUCT DETAILS:**

- (2) 12mm[0.5"] INSERTS
- PAD OPENING: 450mm[17.5"]x1200mm[47"]
- PAD OPENING EXPANDABLE TO 450mm[17.5"]x1400mm[55"]

**CUSTOM OPTIONS AVAILABLE**

- CUSTOM OPENINGS

**PRODUCT CODE:**

**E-13TB**

3 PHASE TRANSFORMER PAD

**OUTSIDE DIMENSIONS:**

**0.200m(H) x 2108mm x 2235mm**

**TOTAL WEIGHT:**

**1,960 kg / 4,315 lbs**

**REVISION DATE:**

**NOVEMBER 1, 2017**

REV. # 4